

Orange County  
 North Carolina  
 Plat

Plotted to a Scale of 40 Ch. to an Inch } This plan Represents a tract  
 of Land Survey. for Robert  
 Cheek Lying on the Waters of New Hope. Adjoin-  
 ing the Land of Tho. Estridge George Breasse George  
 Long Andrew Michael & Jacob Mason

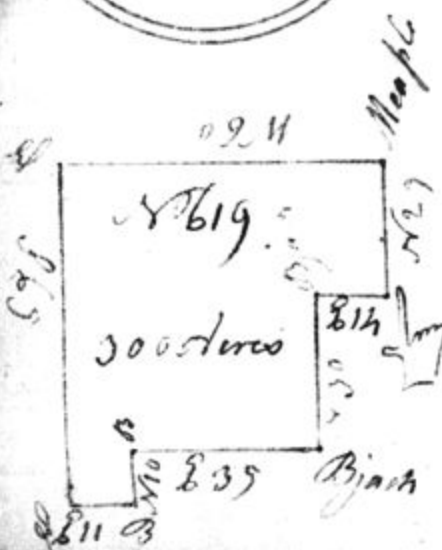

Beginning at a Post oak Running thence North  
 Twenty five Ch. to a maple then West Sixty  
 Ch. to a Black oak then South Sixty five Ch.  
 to a Post oak then East Eleven Ch. to a Black oak  
 then North Ten Ch. to a Black oak then East  
 Thirty five Ch. to a Black jack then North Thirty  
 Ch. to a Black jack then East Fourteen Ch. to the  
 first Station containing 300 acres Survey.  
 the 20<sup>th</sup> Dec 1779  
 Tho<sup>s</sup> Mulholland Esq

George Long }  
 Jno. Michael } Surveyors